

STUDIOCITY

TORONTO

416.778.2500 studiocitytoronto.ca

STUDIOCITY
TORONTO



Studio City Toronto is located in the vibrant Leslieville neighborhood, which features some of the city's best food and drink. It's also just a short drive to world-class hotels and to the downtown core.

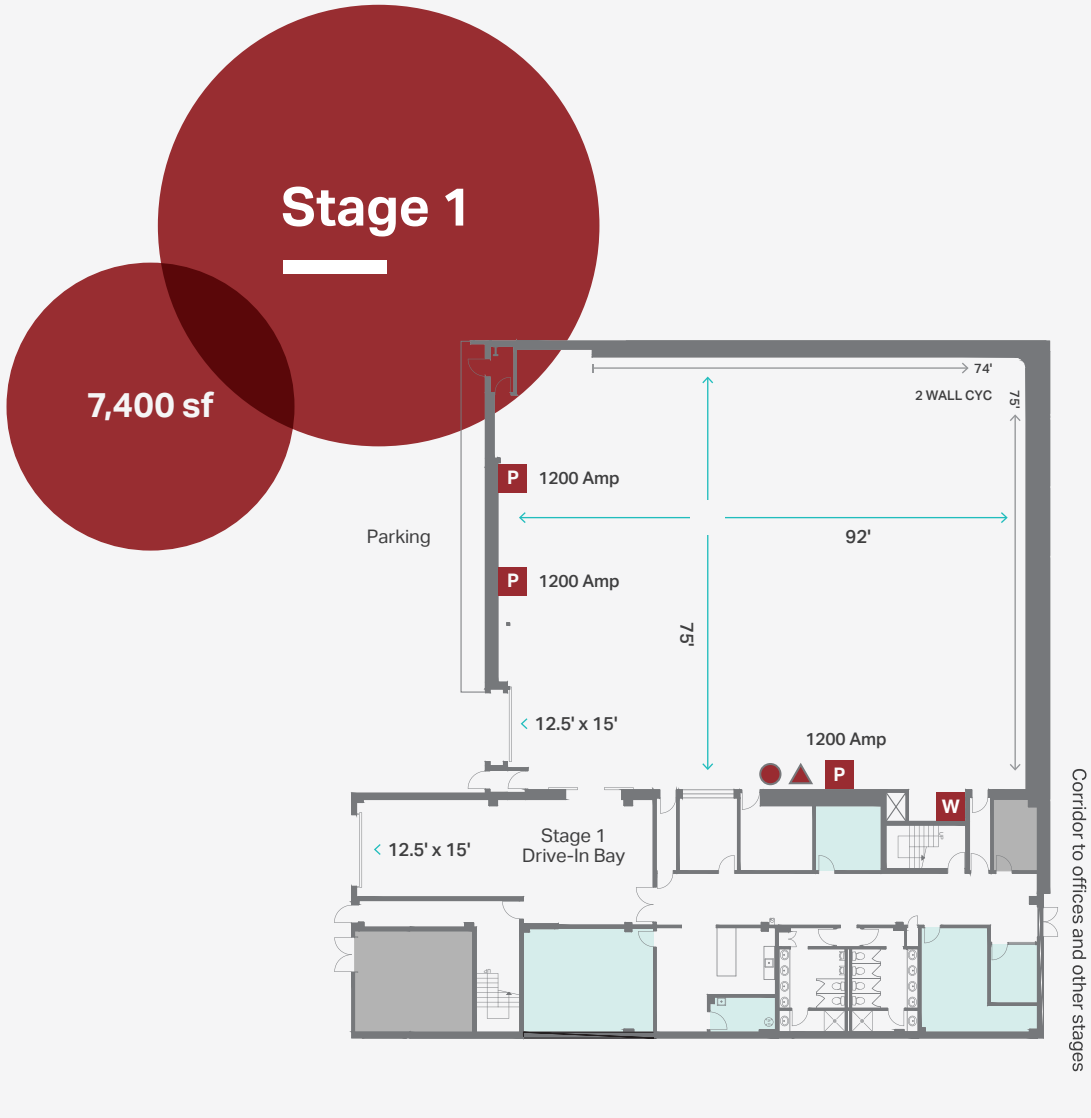

2-Wall Cyc w/Cove: 74' x 75'

Wall to Wall Dimensions: 92' x 75'

Clear Height to Lighting Grid: 32', 2"

Powered Grid

● Bell / Light Console

■ P Power: 1200 amp / 3 phase

■ W Slop Sink



0 48 feet

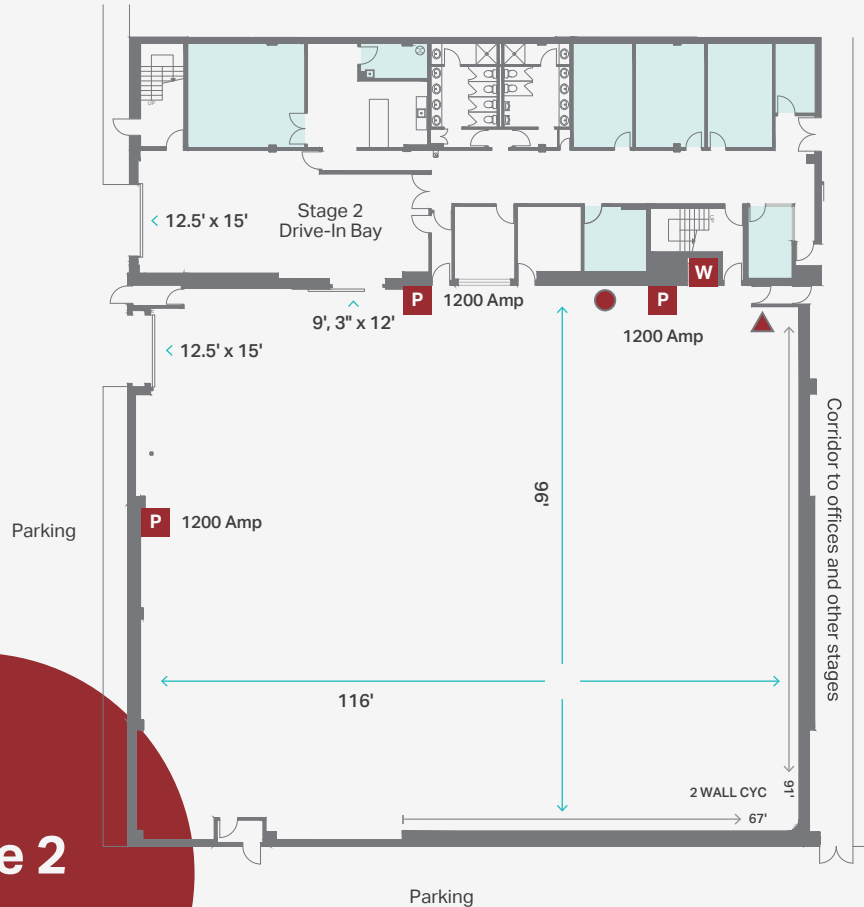





11,300 sf

Stage 2



0 48 feet

-  2-Wall Cyc w/Cove: 67' x 91'
- Wall to Wall Dimensions: 116' x 96'
- Clear Height to Lighting Grid: 32', 2"
- Powered Grid
-  Bell / Light Console
-  Power: 1200 amp / 3 phase
-  Slop Sink

Stage 3

13,700 sf

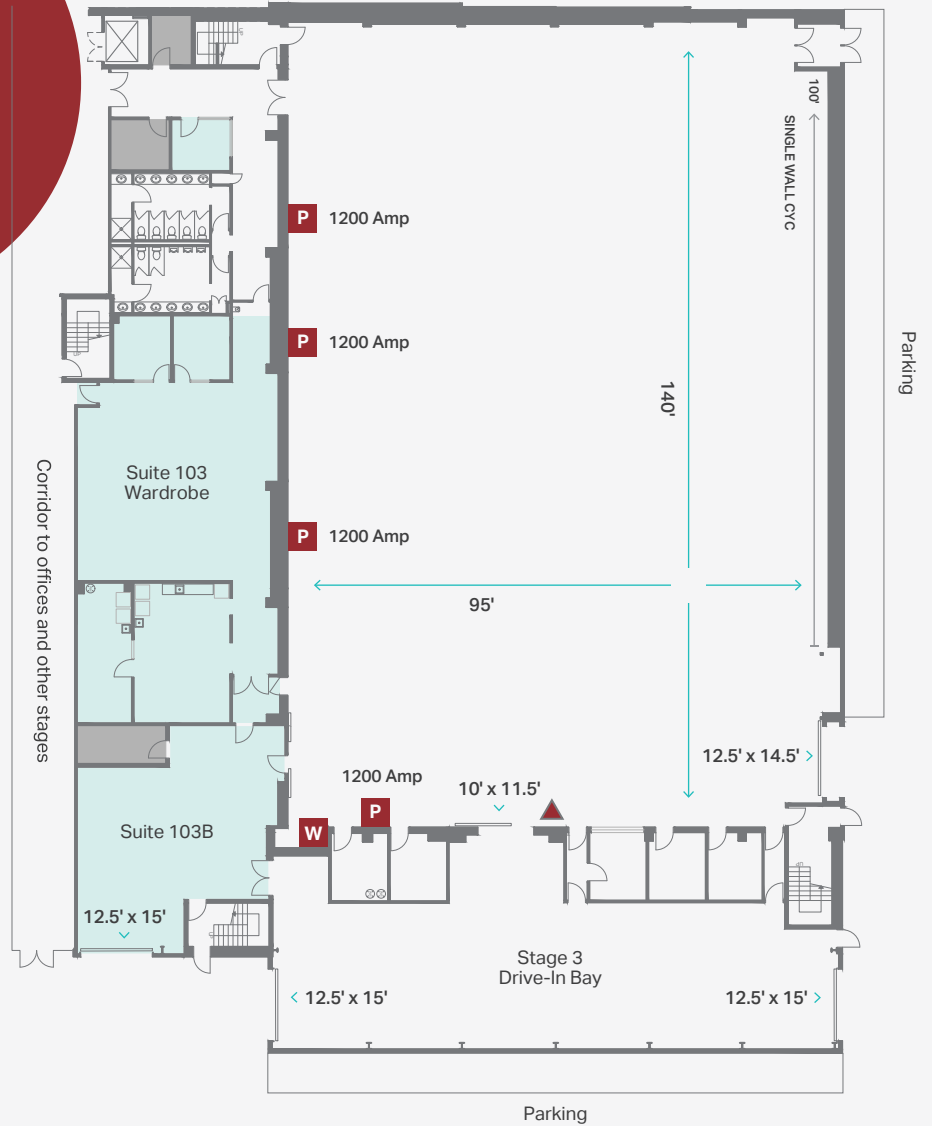

0 48 feet

Single Wall Cyc: 100'

Wall to Wall Dimensions: 140' x 95'

Clear Height to Lighting Grid: 39', 11"

Powered Grid

● Bell / Light Console

P Power: 1200 amp / 3 phase

W Slop Sink

Second Floor



0 48 feet

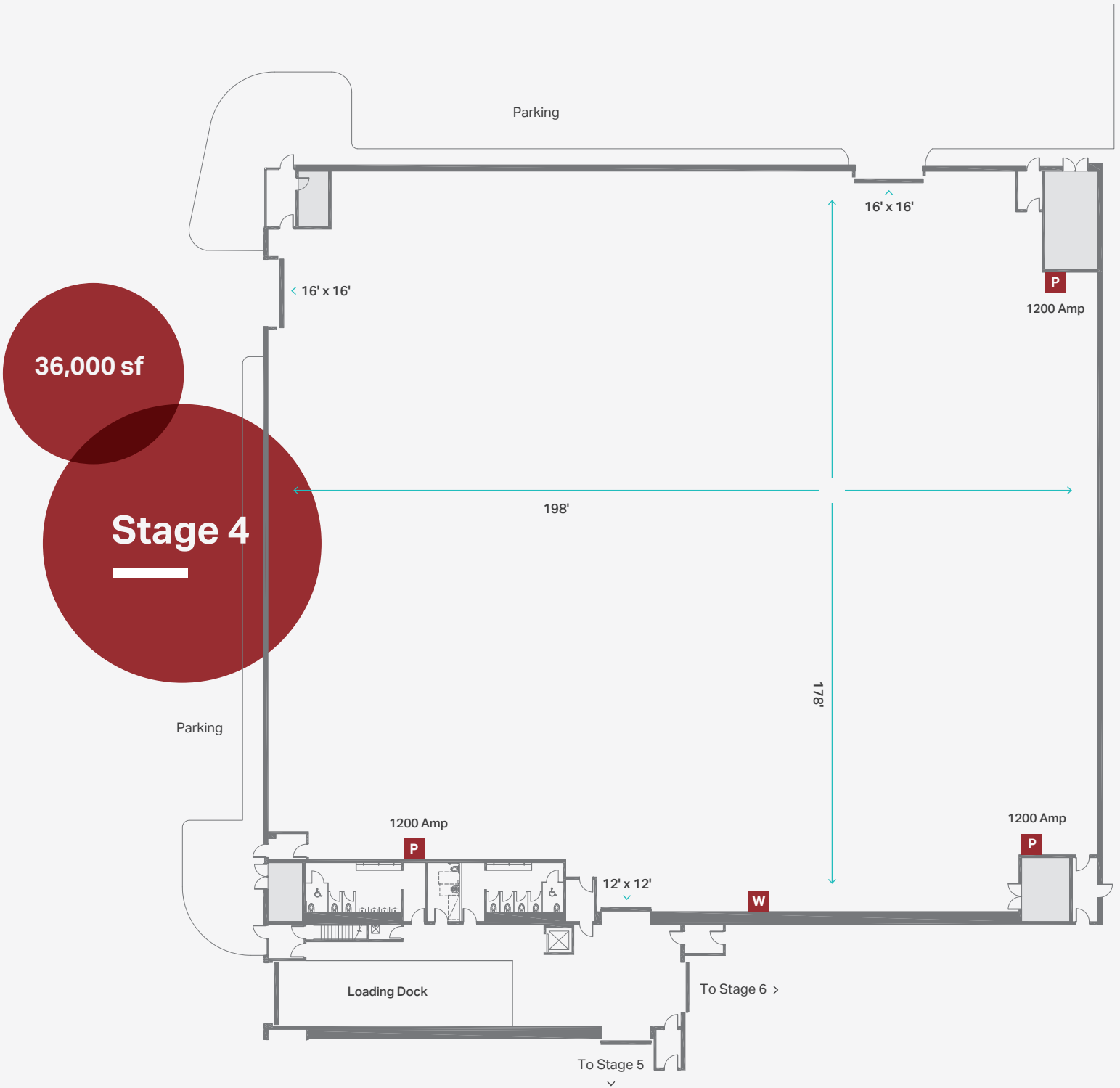

36,000 sf

Stage 4



0 48 feet



Wall to Wall Dimensions: 198' x 178'
Clear Height: 55' to peak

P Power: 1200 amp / 3 phase
W Slop Sink

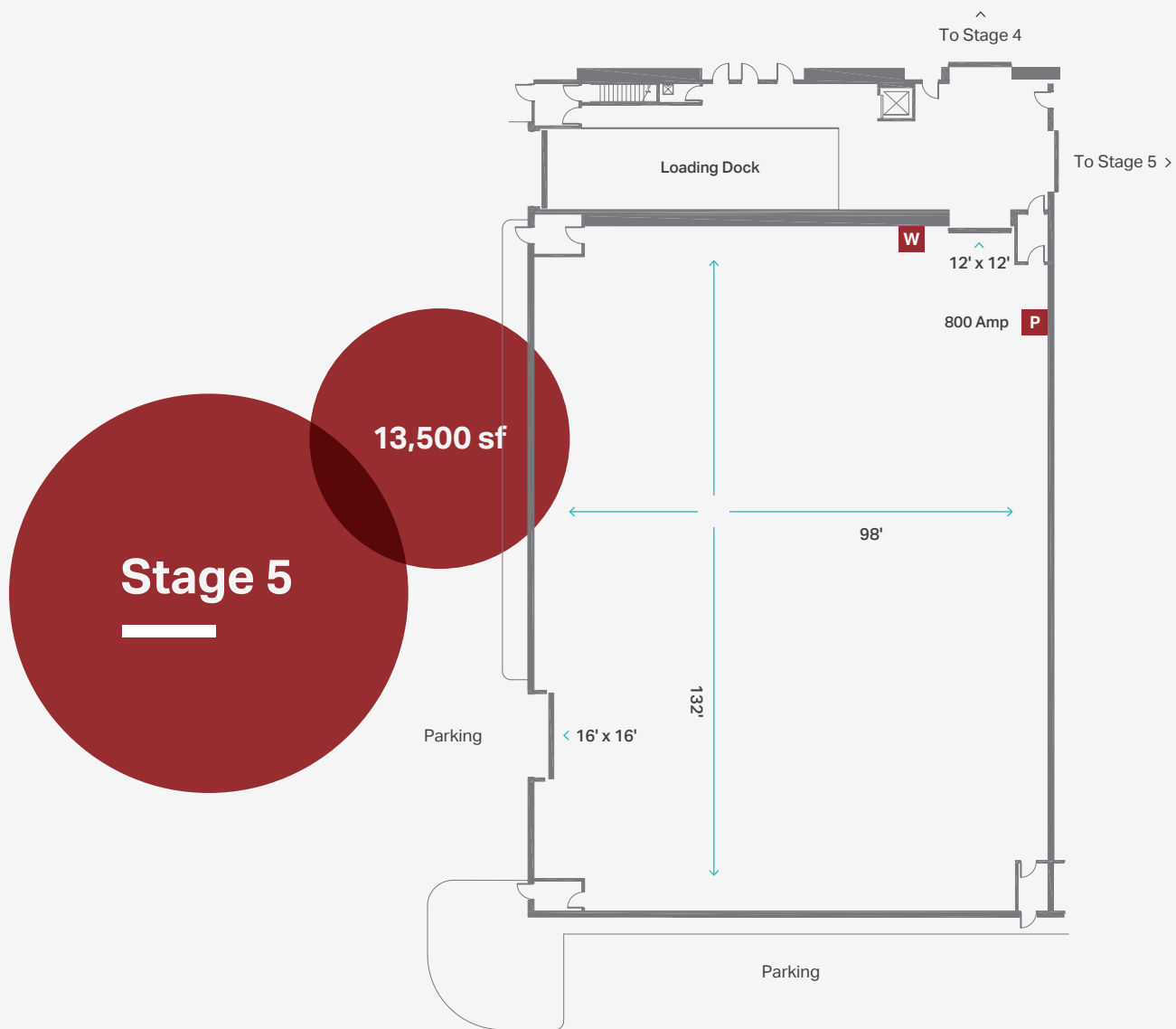

0 48 feet

Wall to Wall Dimensions: 98' x 132'
Clear Height: 35'

P Power: 800 amp / 3 phase
W Slop Sink

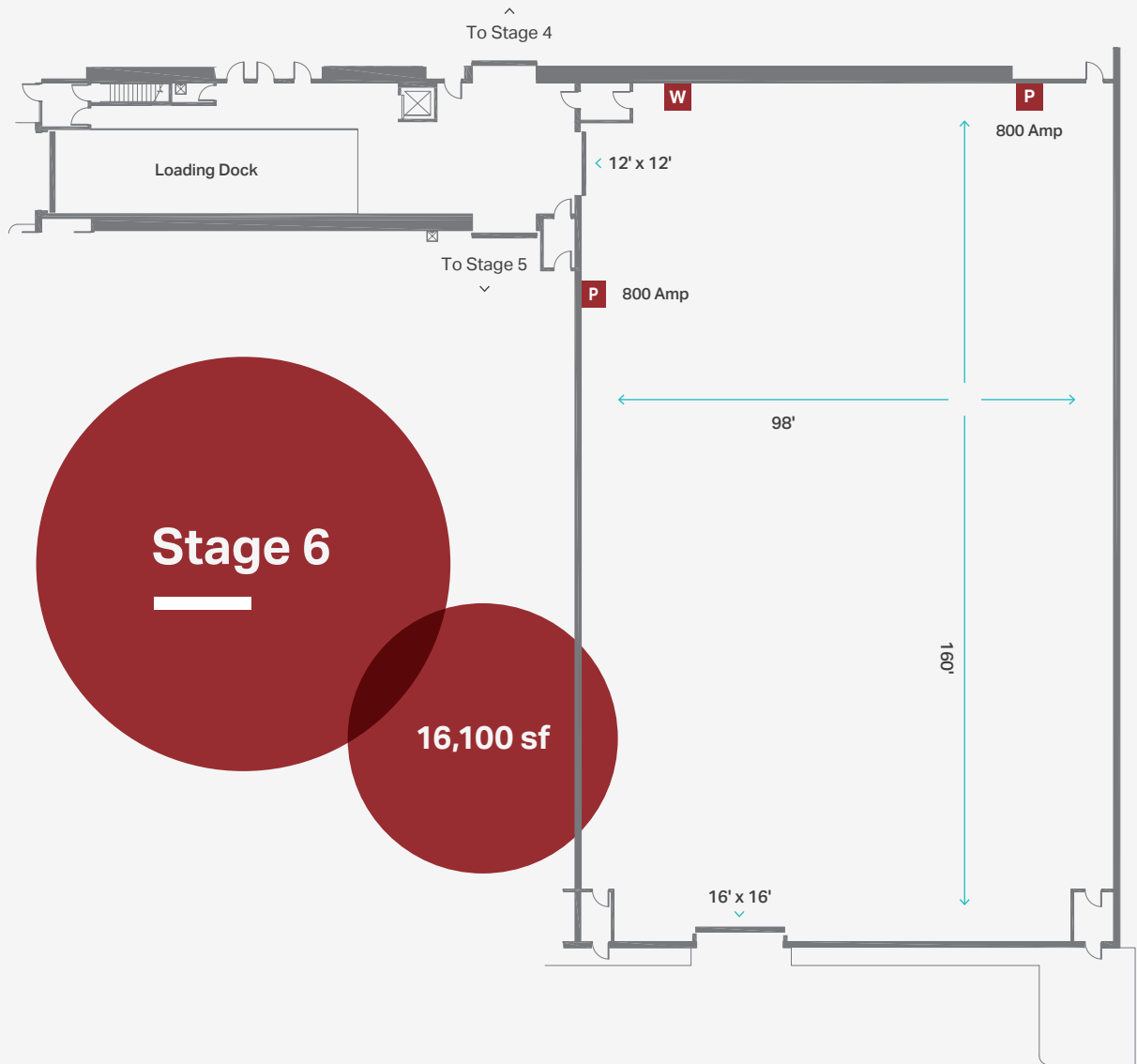

N

0 48 feet



Wall to Wall Dimensions: 98' x 160'
Clear Height: 35'

P Power: 800 amp / 3 phase
W Slop Sink

Site Plan

148,000 sf
of studio
space

LAKE SHORE BLVD

